

MEGAWHEELS®

MODEL

S1

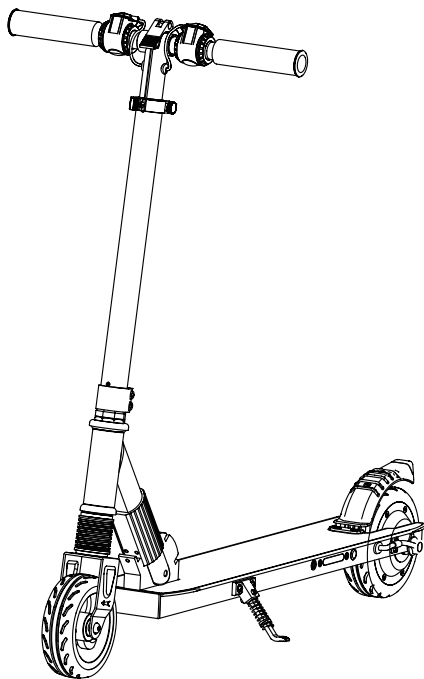

USER'S MANUAL

Thank you for purchasing our product. For optimum performance and safety, please read these instructions carefully before using the product. Please keep this user manual for future reference.

In order to continue serving our customers and providing the best products, our product information including user manual may receive updates continually. Please check our website (megawheels.com) for the latest user manual and product materials.

Thank you for your purchase of the scooter by MEGAWHEELS® !

You're about to take the next step in the evolution of transportation. The MEGAWHEELS scooter will offer you funny riding experience after you take few minutes to learn how to ride it.

To ensure your safety and the safety of others, please read and follow the guidelines in this User Manual carefully and thoroughly before riding.

If you have any questions or concerns, send us an email or call us at 001-855-783-1888 for further assistance. MEGAWHEELS Team will offer full support and service until you satisfied with your purchase!
Happy Riding!

-MEGAWHEELS® Team

CONTENTS

1 GENERAL INFORMATION	03
1.1 WHAT'S IN THE BOX?	03
2 FEATURES	04
2.1 ASSEMBLY	04
2.2 UNFOLDING	04
2.3 FOLDING	05
2.4 STANDING	05
2.5 ADJUST THE HEIGHT OF EXTENSION POLE	06
2.6 TURN ON/TURN OFF	07
2.7 DIAGRAM	08
3 BATTERY & CHARGING	09
3.1 CHARGING YOUR SCOOTER	09
3.2 BATTERY SAFETY WARNING	10
4 USAGE & RIDE THE SCOOTER	12
4.1 HOW TO RIDE THE SCOOTER?	12
4.2 PRACTICING GUIDELINES	13
4.3 WEIGHT & SPEED LIMITATIONS	14
4.4 OPERATING RANGE	14
5 SCOOTER SAFETY PRECAUTIONS	15
6 MAINTENANCE	18
6.1 CLEANING	18
6.2 STORAGE	18
7 SPECIFICATIONS	19
8 WARRANTY	20
CONTACT US	

1 General Information

The original scooter is an intuitive, technologically advanced solution. Using the latest technology and production processes, each scooter undergoes strict testing for quality and durability. With its lightweight, portable design, ease of use, range, and low carbon footprint.

Before using this vehicle, please read all instructions. This User Manual will guide you through the functions, usage, and proper care of your S1 scooter. If you have any questions or cannot find the information you need in the manual, please contact your place of purchase or our customer service immediately.

1.1 WHAT'S IN THE BOX?

1* MEGAWHEELS S1 electric scooter

2* Handles

1* Charger

1* User manual

1* Withdrawal tool set

2 Features

Please read the user manual in its entirety before using the MEGAWHEELS scooter so that you may fully understand its parts and functions and be able to operate it safely.

2.1 Assembly

The Smart S1 Kick Scooter can be assembled within 2 minutes, follow this sketch to install the left &right handles carefully (We must pay attention to the direction of tightening the handles). The design principle of scooter is to tighten the handles in a counter-clockwise direction, which can prevent the handles from loosening when riding the vehicle.

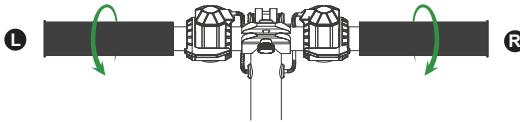

2.2 Unfolding

You can unfold the Smart Kick Scooter without any inconvenience in seconds.

- 1). Unscrew the holding screw near folding tube before unfolding.
- 2). Pull up the tube of the folding construction, then pull up the front pole, when bottom of the folding tube goes into the slot, the unfolding completed.
- 3). Screw down the holding screw.

Note: Users must screw down the holding screw after unfolding the scooter, or the scooter will shake a lot or have unexpected noise when riding.

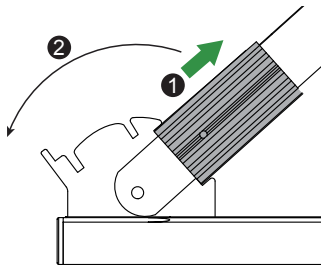

2.3 Folding

The MEGAWHEELS S1 Electric Scooter can be folded in a few seconds. Pull up the tube of folding construction (if you feel it is a little tight, unscrew the holding screw anticlockwise and try again), then push down the front pole, when bottom of the folding tube goes into the slot, the folding completed.

Note: Before moving, lifting, or otherwise transporting the scooter, please make sure you have turned it off. Fold the scooter and grasp it firmly before lifting and/or moving it.

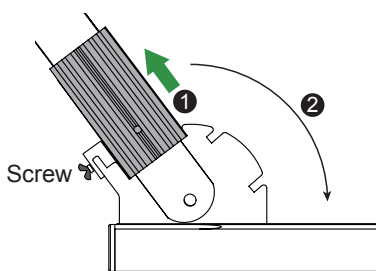

2.4 Standing

The scooter includes a kickstand. Before using the kickstand, bring the scooter to a complete stop and turn it off. Before riding the scooter again, lean the scooter off the kickstand and push the kickstand up.

1. Locate the kickstand on the side of the scooter's deck.
2. Push the kickstand down and away from the scooter. Then carefully lean the weight of the scooter onto the kickstand.

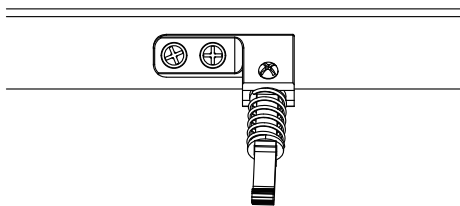

2.5 Adjust the height of extension pole

- 1. Open the lock buckle of extension pole.
- 2. Press down height lock button (the metal bead in hole of extension pole), and pull extension pole to the length (3 levels of height for options) to fit rider's height. When the bead ejects from the hole, the height is fixed.
- 3. Close the lock buckle of extension pole.

Note:

- The extensive height is prohibited to exceed the first upper Limit hole.
- The metal bead must be perfectly placed into the hole on extension pole when the extensive height is finalized.
- Before riding, user must fasten the lock buckle first.

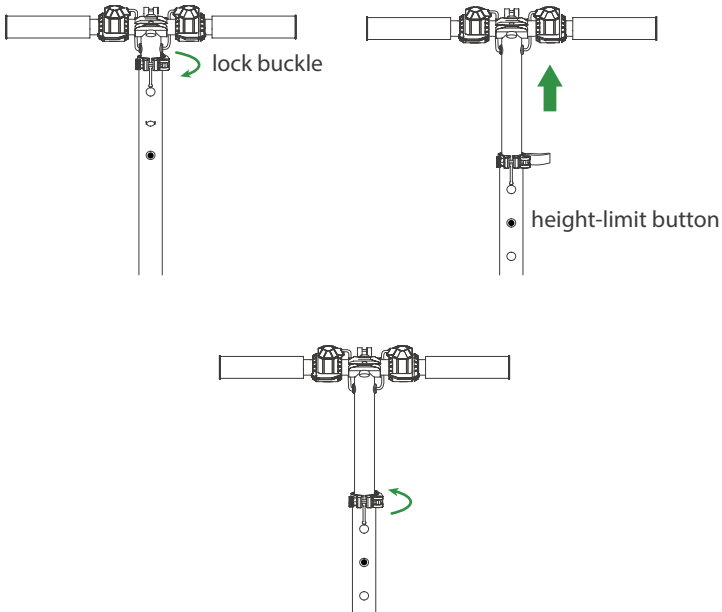

2.6 Turn on / Turn off

To turn on or turn off the MEGAWHEELS S1 electric scooter, users should long-press the power button for about 3 to 5 seconds, but not just press the button and release your finger immediately. Then the LED light near power button will light up, and the scooter is on.

It is same operation to turn off the S1 electric scooter. Long-press the power button for about 3 to 5 seconds and the LED light will go out, the S1 has been turned off.

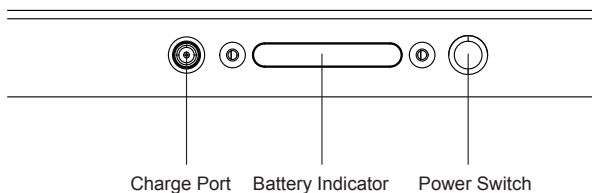

2.7 Diagram

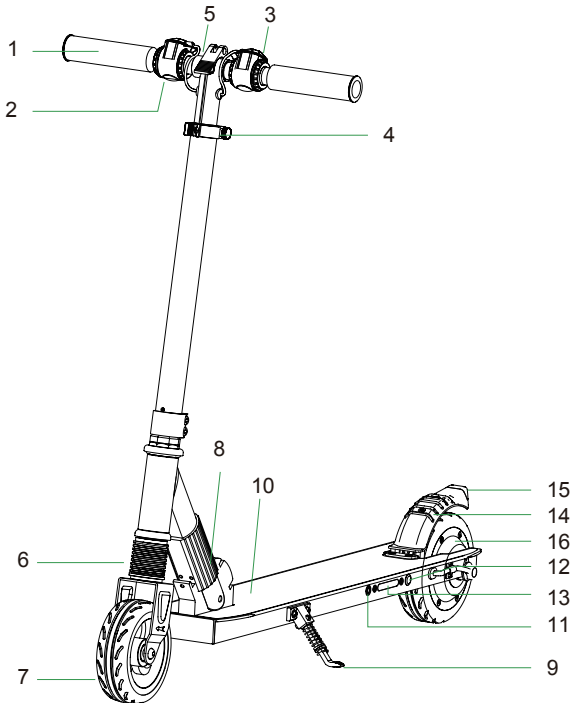

- | | |
|-------------------|------------------------|
| 1. Handle | 9. Kickstand |
| 2. Throttle | 10. Deck |
| 3. Handbrake | 11. Charging Port |
| 4. Lock Buckle | 12. Power Button |
| 5. Handlebar Stem | 13. Battery Indicator |
| 6. Damping Spring | 14. Emergency Brake |
| 7. Front Wheel | 15. Vibration Light |
| 8. Folding Latch | 16. Rear Wheel (Motor) |

3 BATTERY & CHARGING

This section is intended to provide you basic information about your battery and charger. Please read this section carefully to ensure user safety and to prolong the life of your battery, as well as improve battery performance.

3.1 Charging Your Scooter

Charge the MEGAWHEELS before using it. When battery indicator LED lights show that the battery power is low, use the included charging cable and its adapter to charge the MEGAWHEELS S1 electric scooter.

Step 1. Ensure the scooter is turned off before charging and remains off while charging.

Step 2. Remove the cap covering the charger port, ensure that the charging port is clean and dry.

Step 3. Plug the charger into the power socket, now the light on the charger is green. Then plug in the charging port on scooter, while charging, the charger light will turn red.

Step 4. When the scooter is fully recharged, the charger light will turn green again. You may then disconnect the scooter from the charger.

IMPORTANT NOTES ON CHARGING

- DO NOT under any circumstances use the scooter while it is charging or connected to the charger.
- The charging time is approximately 3 hours. Charging longer than that may affect battery life and/or performance. If the charger's light doesn't turn on, it may not be fully connected. Check that it is securely connected to the power supply and to the scooter.
- The best charging temperatures are between 0°~40°. Extreme cold and extreme heat will prevent your battery from charging fully.
- Use only the scooter charger that you received within your box with your scooter.
- Only the indicator light on the charger will tell you the status of the battery during charging.

3.2 Battery Safety Warning

User Fails to follow the Safety Precautions listed in the Battery Warning could lead to serious bodily injury. Seek immediate medical attention if you are exposed to any substance that is emitted from the battery.

When using the battery

(1). Misusing the battery may cause the battery to get hot, rupture, or ignite and cause serious injury. Be sure to follow the safety rules listed below:

- Do not place the battery in fire or direct contact with heat.
- Do not pierce the battery with sharp objects, strike the battery with a hammer, step on the battery, or otherwise subject it to strong impacts or shocks.
- Do not expose the battery to water or any liquids, or allow the battery to get wet.

(2). Do not modify, change or replace the battery. The battery contains safety and protection devices which, if damaged, may cause the battery to generate heat, rupture or ignite.

(3). Do not place the battery on or near fires, stoves, or other high-temperature locations. Do not place the battery in direct sunlight, or use or store the battery inside cars in hot weather. Using the battery in this manner may also result in a loss of performance and a shortened life expectancy.

Note:

- If the device is to be used by children, the caregiver should explain the contents of the user manual to the children. The caregiver should provide adequate supervision to ensure that the device is being used as explained in the user manual.
- Immediately discontinue use of the battery if, while using, charging, or storing the battery, the battery emits an unusual smell, feels hot, changes color, changes shape, or appears abnormal in any other way.
- Do not place the batteries in microwave ovens, high-pressure containers, or on induction cookware.
- In the event that the battery leaks and the fluid gets into one's eye, do not rub the eye.

Rinse well with water and immediately seek medical care. If left untreated, the battery fluid could cause damage to the eye.

While Charging

(1) Be sure to follow the rules listed below while charging the battery. Failure to do so may cause the battery to become hot, rupture or ignite and cause serious injury. When charging the battery, use a specified battery charger provided in the package. Do not place the battery in or near fire, or under direct sunlight.

(2) Do not continue charging the battery if it does not recharge within the specified charging time. Doing so may cause the battery to become hot, rupture or ignite.

(3) The temperature range within which the battery can be charged is 32°F ~ 104°F (0°C to 40°C). Charging the battery at temperatures outside of this range may cause the battery to become hot or to break, also harm the performance of the battery or reduce the battery's life expectancy.

When Discharging the Battery

Do not discharge the battery using any device except for the specified device. When the battery is used in devices aside from the specified device it may damage the performance of the battery or reduce its life expectancy, and if the device causes an abnormal current to flow, it may cause the battery to become hot, rupture or ignite and cause serious injury.

4 USAGE & RIDE THE SCOOTER

We sincerely hope that every user can ride the MEGAWHEELS S1 electric scooter safely. Think back to when you first learned to ride a bike, a car or skateboard. Note the following information before attempting to ride your S1.

- Protective gears including helmet, knee pads, elbow pads must be worn before riding.
- The S1 electric scooter supports up to 150 lbs (68kg), we highly recommend it to rider who weighs less than 150 lbs to have a better riding experience and higher range.
- Only operate the scooter where it is permitted. Local laws may restrict where you may ride.
- The MEGAWHEELS contains a motor and may be classified as a motor vehicle under your local law. It is your responsibility to understand and abide by any local laws restricting how or where you may ride.

4.1 HOW TO RIDE THE SCOOTER?

Assuming you have equipped suitable protective gear and that the MEGAWHEELS has been placed on a level surface, is well charged, and does not have any issues, follow the steps below.

Step 1. Press the power button for 3 -5 seconds to turn the scooter on.

Step 2. Locate the kickstand on the side of the scooter's deck.

Step 3. Carefully step on with one foot, kick backward with the other foot to gain an initial velocity of about 10km/h, then press the accelerate throttle to make the scooter have a constant power, and at last, step your other foot on the pedal and keep balance.

Step 4. Skillfully use the accelerate throttle valve to speed up or slow down when riding.

Step 5. To stop riding, release the throttle and use the handbrake to gradually coast to a stop then step off the scooter one foot at a time. Be extra cautions when dismounting for the first time.

NOTE:

(1). When riding the scooter, rider's right thumb should keep holding down the accelerate throttle, or the scooter will slow down and then stop.

(2). When attempting to brake, rider must release the right thumb on the accelerate throttle, and then using the left thumb to constantly press the handbrake valve and slow down. Please remind that don't press the accelerate throttle and handbrake valve simultaneously, which will sharply shorten product life, even harm the motherboard and battery of scooter.

(3). After receiving the scooter, don't forget to unplug the insulating piece on the rear brake, only then can the rear light blink. The taillight carries a sensor, as long as scooter is moving, the taillight will blink. It is powered by few button cells, so when the battery runs out, user can replace them easily.

(4). The rear brake is an emergency device, use only when the handbrake is not working or don't work well. Use the rear brake too often or stamp on it hard may lead to its broken (damage) and abrade the rear wheel.

4.2 PRACTICING GUIDELINES

Practice until you are comfortable with using all of the scooter's functions. See the following tips below.

- Wear casual clothing and flat shoes to maintain your flexibility and stability.
- Practice until you can easily get on, move forward, turn, stop, and dismount with ease.
- Make sure the pavement is even. Do not operate on a slope until you are experienced on it.
- The scooter is designed for relatively smooth, flat terrain. When driving on uneven terrain, the user should slow down.
- Until you are comfortable using the scooter, avoid operating in places with pedestrians or obstacles.
- The S1 electric scooter weights approximately 16.5 lbs (7.5 kg), be sure to lift it firmly when carrying the scooter.

4.3 WEIGHT & SPEED LIMITATIONS

(1). The max loading for the scooter is about 150 lbs (68kg). We highly recommend it to riders who weigh less than 150 lbs to have a better riding experience and get a higher range.

(2). Max speed: 23km/h. It is an ideal state that can be affected by rider's weight and road condition.

4.4 OPERATING RANGE

Please notice that the scooter can travel a distance of 8-12 km on a fully charged battery in ideal conditions. The following are some of the major factors that may affect the operating range of your scooter.

(1). Terrain: A smooth, flat surface will increase your driving distance, while driving uphill, as well as rough or uneven terrain will reduce your distance significantly.

(2). Weight: The weight of the user can affect driving distance, a lighter user will have further range than a heavier user.

(3). Ambient temperature: Please ride and store the scooter under recommended temperatures, which will increase driving distance, battery life, and overall performance of your scooter.

(4). Maintenance: Reasonable battery charging and maintenance will increase the distance. While overcharging the scooter can reduce its range.

(5). Speed and Driving Style: Maintaining a moderate speed will increase your distance, while travelling at high speeds for extended periods, frequent starts, stops, idling, along with frequent acceleration and deceleration will reduce your overall distance.

5 SCOOTER SAFETY PRECAUTIONS

On this section, we will list some safety precautions for scooter riding. Rider fails to follow any of the following safety precautions can and may lead to damage to your scooter, void your manufacturer warranty, lead to property damage, cause serious bodily injury, and can lead to death.

- (1). Please wear all appropriate safety and protective gear as previously mentioned in the User Manual before operating the scooter.
- (2). Make sure to wear comfortable clothes and flat closed toe shoes when operating your scooter.
- (3). Please carefully read the User Manual, which will assist in explaining the basic working principles and provide tips on how to best enjoy your scooter experience.
- (4). Do not try to open or modify your scooter, as doing so will violate your manufacturer warranty, and may cause failure to your device leading to serious bodily injury or death.
- (5). Do not use the scooter to place yourself or anyone else and their property in danger.
- (6). Do not operate the scooter while under the influence of drugs and/or alcohol.
- (7). Do not operate the scooter when you are restless or sleepy.
- (8). Use your best judgment to keep yourself out of dangerous situations with your scooter.
- (9). Do not ride your scooter off of curbs, ramps, or attempt to operate in a skate park, empty pool, or in any ways similar places.
- (10). Do not turn sharply, especially at high speeds.
- (11). Do not abuse your scooter, doing so can damage your unit and cause failure to the operating system which can lead to injury.

- (12). Do not drive in or near puddles of water, mud, sand, stones, gravel, debris or near rough and rugged terrain.
- (13). The scooter can be used on paved roads that are flat and even. If you encounter uneven pavement, please lift your scooter over and past the obstruction.
- (14). Do not ride the scooter in inclement weather: snow, rain, hail, sleet, on icy roads or in extreme heat weather.
- (15). Do not ride in or near pools or other large bodies of water.
- (16). For Bumps and Uneven pavement-Bend your knees when riding on bumpy or uneven pavement to absorb the shock and vibration and help you keep your balance. If you are unsure if you can safely ride on a specific terrain, step off and carry your scooter.
- (17). Do not attempt to ride over bumps or objects greater than 1.5cm even when prepared and bending your knees.
- (18). PAY ATTENTION - look at where you are riding and be cognoscente of the road conditions, people, places, property and objects around you.
- (19). Do not operate the scooter in crowded areas.
- (20). Operate your scooter with extreme caution when indoors, especially around people, property, and narrow spaces like doorways and other narrow spaces.
- (21). Operate your scooter with extreme consideration for people and property at all times.
- (22). Do not operate the scooter while talking, texting, or playing with your phone.
- (23). Do not ride your scooter where it is not permitted.
- (24). Do not ride your scooter near motor vehicles or on public roads.
- (25). Do not climb or travel down steep hills with your scooter.

- (26). The scooter is intended for use by a single individual, DO NOT attempt to operate the scooter with two or more people.
- (27). Do not carry anything while riding the scooter.
- (28). Individuals with lack of balance should not attempt to operate the scooter.
- (29). Women who are pregnant or who may become pregnant should not operate the scooter.
- (30). Young children and the elderly should not operate the scooter without proper instruction and supervision from a Certified scooter trainer.
- (31). At higher speeds, always take into consideration longer stopping distances.
- (32). Do not step forward off your scooter.
- (33). Do not attempt to jump on or off your scooter.
- (34). Do not attempt any stunts or tricks with your scooter.
- (35). Do not ride the scooter in dark or poorly lit areas.
- (36). Do not ride the scooter near or over potholes, cracks or uneven pavement.
- (37). Do not operate your scooter off-road.
- (38). Do not exceed the maximum or minimum weight limits.
- (39). Avoid driving the scooter in unsafe places, including near areas with flammable gas, steam, liquid, dust, fiber, which could cause fire and explosion accidents.

6 MAINTENANCE

Your scooter requires routine inspection and maintenance. This chapter will describe the maintenance steps and important operating tips. Before you perform the following operations, be sure to disconnect your charger and turn off your scooter.

6.1 CLEANING

The scooter may need cleaning after riding for extended periods of time. See the following tips below.

- Completely power off the scooter before cleaning.
- Use dry, non-abrasive cloth to gently remove debris or dust.
- The scooter should not contact with any kind of liquid.
- Never use alcohol or ammonia-based cleaning solutions.
- Never spray liquid directly onto any part of the scooter.

6.2 STORAGE

The scooter may be stored easily when not in use. See the following instructions.

- Before storing, fully charge the scooter to prevent battery over-discharge due to non-use.
- Cover the scooter to protect it from dust. Do not store in a dusty environment and with all electronic devices.
- Store the scooter indoors at suitable temperatures between -0°C to 45°C .
- If storing for more than one month, discharge and recharge the battery every three months.
- DO NOT store in an unheated garage, shed, or other location with extreme temperature fluctuations or ranges.

Note: Do not perform any maintenance when the power is on or the battery is charging. Do not let water or liquids get into the scooter. It will cause permanent damage to the internal electronic components.

7 SPECIFICATIONS

ITEM	PARAMETER
Net Weight	7.5kg
Gross Weight	10kg
Max. Loading	68kg
Motor	200W
Max. Speed	23km/h
Range	8-12km
Max Climbing Limit	15 degrees
Battery	Lithium-ion, 5.0Ah, 25.2V
Power Requirement	AC 100-240V / 50-60Hz
Charging Time	3 hours
Size (fold)	900*420*290mm
Size (unfold)	810*420*(920-1020)mm
Box Size	870*207*333mm
Wheel Size	6" (front wheel), 5.5" (back wheel)
Shaking Absorb	Yes
Stand	Yes
Tire	Solid tire

8 WARRANTY

Your MEGAWHEELS scooter includes a One Year Limited Hardware Warranty ("Warranty"). The Warranty covers product defects in materials and workmanship under normal use. This Warranty is limited to residents of the United States and is available only to original purchasers.

This Warranty starts on the date of your purchase and lasts for one year (the "Warranty Period").

The Warranty Period is not extended if the Product is repaired or replaced.

We may change the availability of this limited warranty at our discretion, but any changes will not be retroactive.

Warranty services are provided by MEGAWHEELS™. If a hardware defect arises and a valid claim is received within the Warranty Period, at its option and to the extent permitted by law, MEGAWHEELS™ will:

- (1) Repair the hardware defect by using new or refurbished parts that are equivalent to new in performance and reliability;
- (2) Exchange the Product with a product that is new or refurbished which is substantially equivalent to the original product. This Warranty is for one replacement only of like-items and does not cover items out of production if the product is no longer made or stocked.

This Warranty is not assignable or transferable.

This warranty only covers technical hardware defectiveness during the warranty period and under normal use conditions. MEGAWHEELS™ does not warrant uninterrupted or error-free operation of this Product.

Terms & conditions (Refund /Replacement /Maintenance)

(1) When purchase time (from the time when customer bought the product) is less than 1 month, we can offer refund or replacement;

(2) When purchase time is 1-3 months, free maintenance or replacement will be available, and we will cover the shipping and maintenance fees;

(3) When purchase time is 3-6 months, we offer free maintenance and pay the shipping fee to send it back to customer, but customer should cover the shipping fee to send the defect product back to us;

(4) When purchase time is 6-12 months, we only offer free maintenance, customers should pay for all the shipping fees.

The following conditions are not covered by the warranty, only the maintenance service is provided but the maintenance fee is charger.

(1) Damage caused by any man-made factors, including improper use and failure to keep in accordance with the instructions.

(2) This limited warranty doesn't cover any problem that is caused by conditions, malfunctions, or damage not resulting from defects in material or workmanship. This conditions may include, but not limited to, road hazards, accidents and improper operation or maintenance.

Important: Do not disassemble the Product. Disassembling the Product will void this Warranty. Only MEGAWHEELS™ or a party expressly authorized by MEGAWHEELS™ should perform service on this Product.

CONTACT US



<https://www.megawheels.com>

NEED HELP?

Send us e-mail for replacement parts and product support.

amz-jlk@hotmail.com

For Amazon Customer Support

mega-jlk@hotmail.com

For eBay Customer Support

support@megawheels.com

For Official Website Customer Support

Or call our customer service line on:

US Local Service : (626) 453-0189

Global Free Call: 001-855-783-1888